

## GG15 Spring Loaded Latch Handle

### Features

- Very useful, plant-on 'chest' handle, with attached backplate and concealed spring which returns to 'rest' position
- Stainless steel throughout, with 'grip' in resilient rubber
- Also available for surface mounting (without recess plate) on special order
- Angle of opening 85°
- Panel cut-out dimensions 75 mm x 127 mm



### Material

- Stainless steel

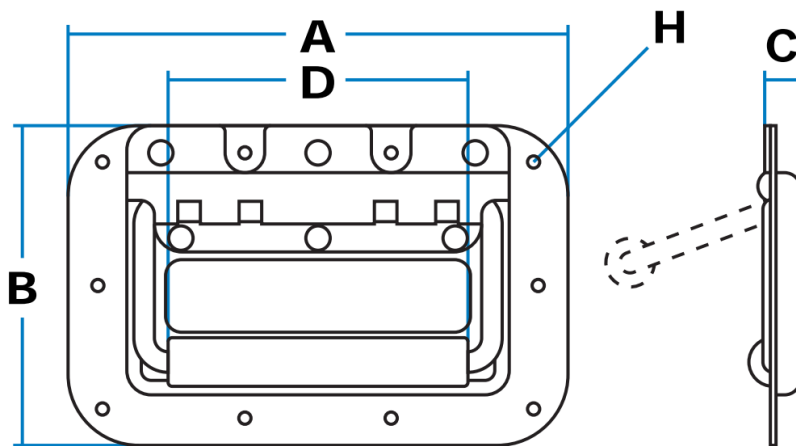

Part No.	A	B	C	D	E	H
GG15-G01914SS	160	107	6	110	12	6